

3. Flight control:

**Hover up and down:**  
When the helicopter flies steadily, you can slowly push the throttle stick up to make helicopter fly higher, or lower the stick a bit to make helicopter fly lower. Only small amounts of stick position change are required for smooth flying. (fig.7 & fig.8)

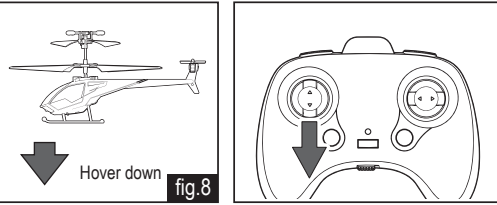
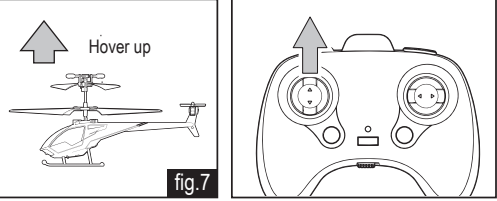

Turn left and right:

Maintain the helicopter at a certain height. Push the direction stick toward left to turn counter clockwise (fig.9), and push the direction stick toward right to turn clockwise. (fig.10)

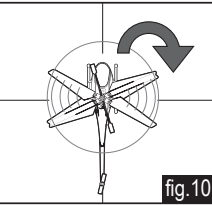
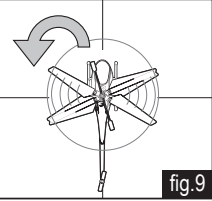

4. Lift-off Procedures (after trimming procedure):

- Put the helicopter on a smooth surface. Uneven floor surface will affect its lifting off.
- Slowly increase the throttle.
- DO NOT look at the transmitter but focus on the helicopter.
- As soon as the helicopter leaves ground, reduce the throttle slightly. (in the worst case, helicopter will go back to the floor, but that is better than crashing against the ceiling)
- VERY gently add the throttle if the helicopter goes down.
- VERY gently reduce the throttle if the helicopter goes up.
- For turning, give short and small inputs to the direction stick. (most beginners will easily overcontrol the helicopter)

5. HELICOPTER HEADLIGHT:

- Switch on the helicopter the headlight will light up automatically.

Trouble Shooting

Symptom	Cause	Correction
The helicopter does not response.	- The helicopter and/ or the transmitter is switch off ("OFF"). - The battery of the helicopter is weak.	- Set the power switch to "ON". - Recharge the battery of the helicopter.
Suddenly stop and drop down when flying.	- The battery of the helicopter is weak.	- Recharge the battery of the helicopter.
Loss of control.	- Another infrared control device using the same frequency band. - Affected by strong lighting.	- Point the transmitter to the helicopter. - Change another environment to avoid direct lighting.

Air Mamba™

Become our fan on facebook  
facebook.com/SilverlitToys

Visit us at  
www.Silverlit.com

Part Identification

Helicopter

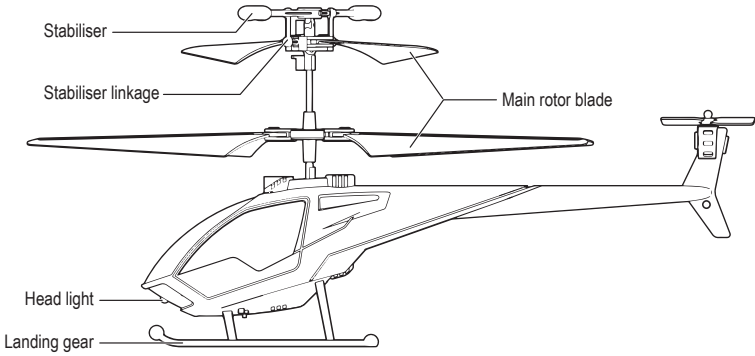

Transmitter

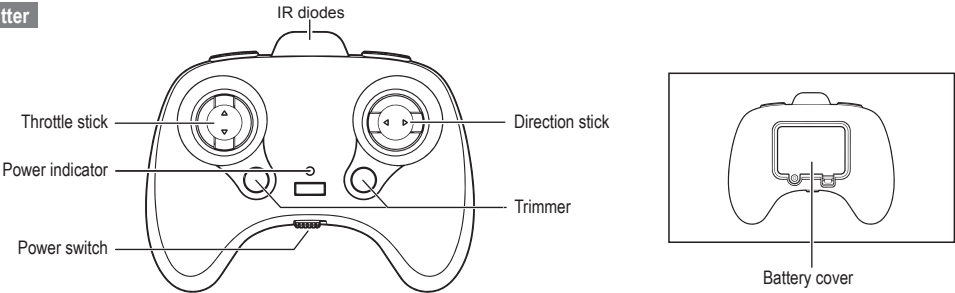

Battery Installation & Charging

Transmitter Battery Installation (\*Make sure the power switch is on "OFF" position.)

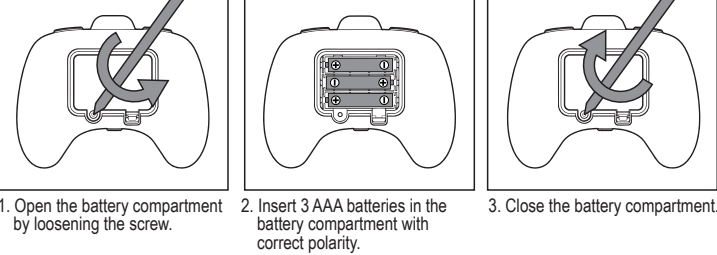

Note: When the power indicator on the transmitter starts blinking, replace the batteries.

Charging Helicopter

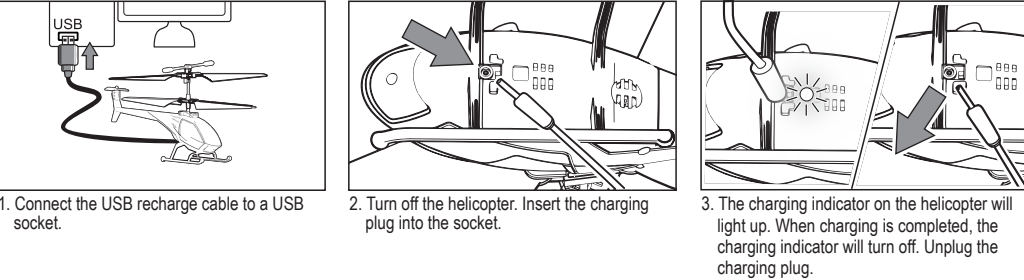

Note: 1. The helicopter can operate for about 5 - 6 minutes per every 25 - 40 minutes charging.  
2. Before recharging the battery, wait 10 - 15 minutes for it to cool down.

AIR MAMBA

For ages 8+



This toy is only to be connected to equipment bearing either of the following symbols:

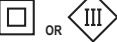

Delivery contents



Precautions, Warnings & Statements

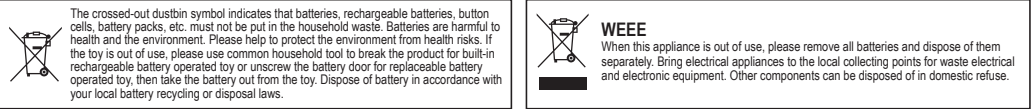

**Safety precautions:**  
**Warning:** Changes or modifications to this unit not expressly approved by the party responsible for compliance could void the user's authority to operate the equipment.  
- The USB cable is tailor-made for charging the LiPo battery in the helicopter. Do not use it to charge any other batteries.  
**USB cable statement:**  
- If battery cannot be charged. Please try another adapter.  
- The product must only be used with the provided USB cable for charging.  
- Do not use high output adapter for battery charging (1A or above).  
- Transformer or battery charger used with the toy are to be regularly examined for damage to the cord, plug, enclosure and other parts, and in the event of such damage, they must not be used until the damage has been repaired.  
**Special notes to adults:**  
- Before first use: read the user's information together with your child.  
- This toy is intended to be used in domestic area (house and garden) only.  
- Do not change or modify anything on the helicopter!  
- Assembly should be performed under adult supervision (changing batteries/ spare parts, trimming etc).  
- Parental guidance is recommended when installing or replacing batteries.

**Battery warnings:**  
- Non-rechargeable batteries are not to be recharged.  
- Rechargeable batteries are to be removed before being charged. (Transmitter only)  
- Rechargeable batteries should be charged under adult supervision.  
- Different types of batteries or new and used batteries are not to be mixed. (Transmitter only)  
- Only batteries of the same or equivalent type as recommended are to be used.  
- Batteries are to be inserted with correct polarity. (+ and -)  
- Exhausted batteries are to be removed from the toy. (Transmitter only)  
- The supply terminals are not to be short-circuited.  
- Do not mix old and new batteries. (Transmitter only)  
- Do not mix alkaline batteries, standard batteries (carbon-zinc) and rechargeable batteries (nickel-cadmium). (Transmitter only)

**This toy is equipped with a LiPo rechargeable battery, please pay attention to the following cautions for safety use:**  
- Do not dispose the battery in fire or heat.  
- Do not use or leave the battery near a heat source such as fire or heater.  
- Do not strike or throw the battery against hard surface.  
- Do not immerse the battery in water, and keep the battery in a cool dry environment.  
- When recharging, only use the battery charger specifically for that purpose.  
- Do not over-discharge the battery.  
- Do not connect the battery to an electrical outlet.  
- Do not directly solder the battery and pierce the battery with a nail or other sharp object.  
- Do not transport or store the battery together with metal objects such as necklaces, hairpins etc.  
- Do not disassemble or alter the battery.  
- Charge the battery every 6 months.  
- This toy (helicopter) contains battery that is non-replaceable

**Notes:**  
- Use new alkaline batteries in this toy to obtain best performance.  
- Do not operate battery charger if it has been damaged in anyway.  
- This toy must only be used with the recommended charger.

**Battery requirement for Transmitter:**  
Power Supply :   
Rating : DC 4.5V , 0.5 W  
Batteries : 3 x 1.5 V "AAA"/LR03/AM4 (not included)

**Battery requirement for Helicopter:**  
Power Supply :   
Rating : DC 3.7 V , 5.2 W  
Batteries : 1 x 3.7 V LiPo Rechargeable Battery Pack (included)

**Care and Maintenance:**  
- Always remove batteries from the toy when it is not being used for a long period of time. (Transmitter only)  
- Wipe the toy gently with a clean damp cloth.  
- Keep the toy away from direct heat.  
- Do not submerge the toy into water that can damage the electronic assemblies.

**The normal function of the product may be disturbed by Strong Electro Magnetic Interference. If so, simply reset the product to resume normal operation by following the instruction manual.**  
**In case the function could not resume, please use the product in other location.**

Flying Your Helicopter

Tip! CONTROLLING

- For controlling the sticks on transmitter, try not to push the sticks immediately any extreme positions. It should be like steering a bicycle rather than pressing computer game sticks.
- For the novice pilot (after the trimming procedure is completed), it is highly recommended to focus exclusively on learning to control the Throttle stick first. If the helicopter turns around by itself there is no need to keep it straight. For the first flight, it is important to learn to keep the helicopter at a constant altitude of around 1 meter with very gentle inputs on the throttle stick. Once the Pilot masters this, he may start learning to take control with the direction stick.

Tip! OPERATION

- After you crash your helicopter, you need to restart the helicopter by slide it's ON/OFF switch to "OFF" and then check for damages. If there is no damage slide the ON/OFF switch to "ON" again.
- Don't operate the helicopter under the direct bright light it will affect the control system of your helicopter.
- Don't cover the IR Diode of the transmitter as it will block the IR signal.
- Don't stick any other label onto the helicopter as it will affect receiving of IR signal.

- Switch on both helicopter and transmitter.
- Place the helicopter on the ground with the tail point towards you and the nose pointing away.

1. Environment for flight:

- Choose the place which meet the following condition:
1. Indoor environment with calm air condition. Beware of the air circulation from the air-conditioner.
  2. Safety area: It is highly recommended that there is no electric fan, air-conditioner, reading lamp or other dangerous objects to flying.

2. Trimming the helicopter:

- Gently push the throttle up to raise your helicopter about 0.5 to 1 meter high.

- When the helicopter spirals (fig.1) or keeps turning clockwise (fig.2), turn the yaw-trim dial to the left until the helicopter flies straight (fig.3).

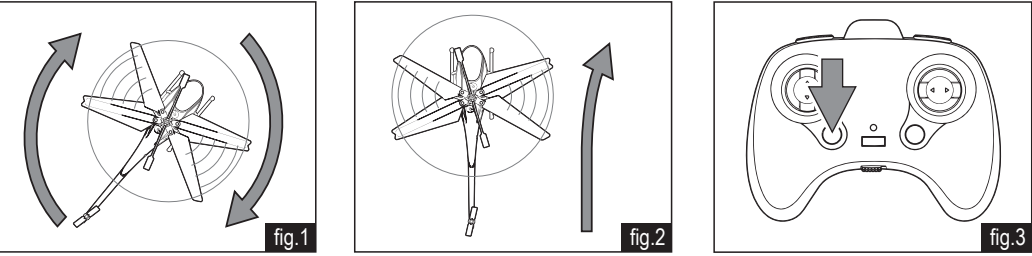

- When the helicopter spirals (fig.4) or keeps turning anticlockwise (fig.5), turn the yaw-trim dial to the right until the helicopter flies straight (fig.6).

