



# Soleil

---







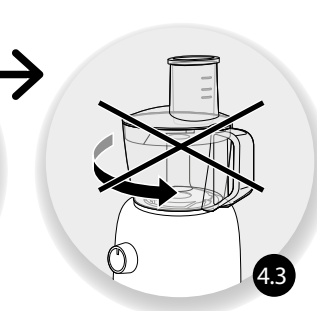
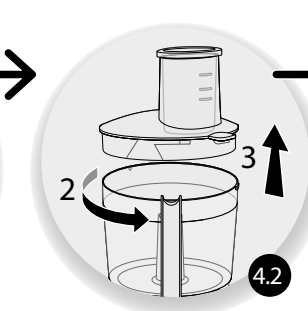
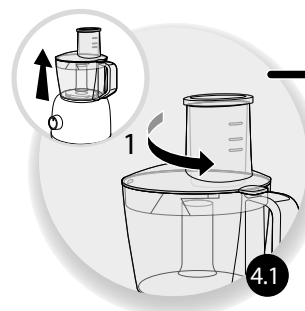
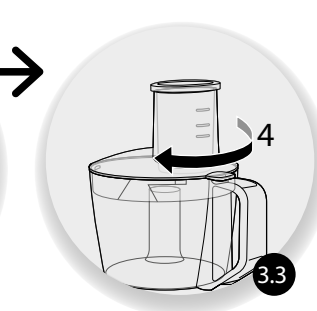
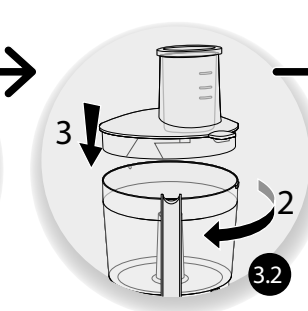
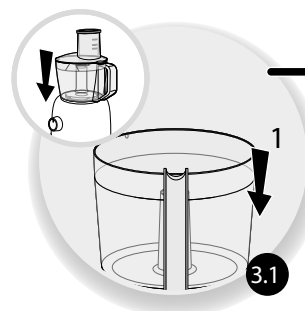
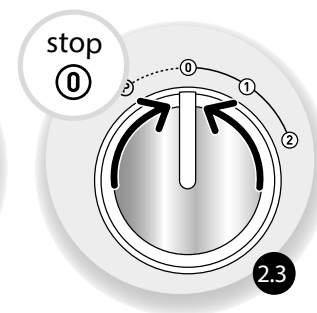
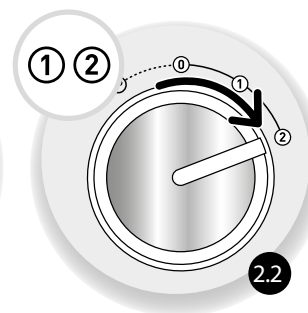
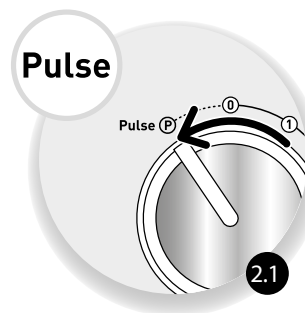
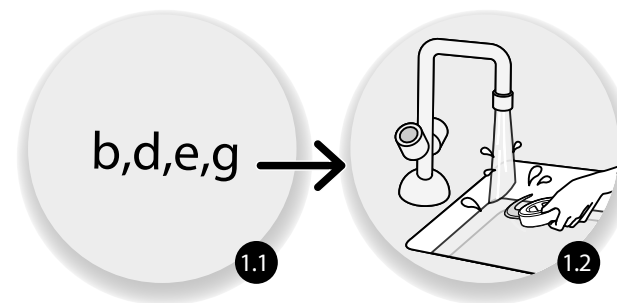
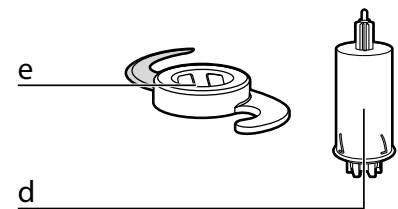
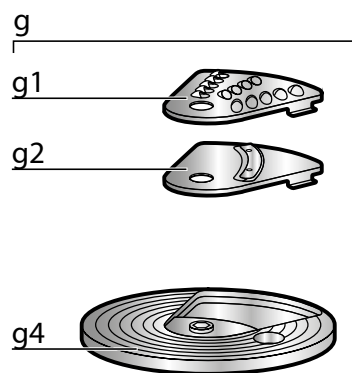
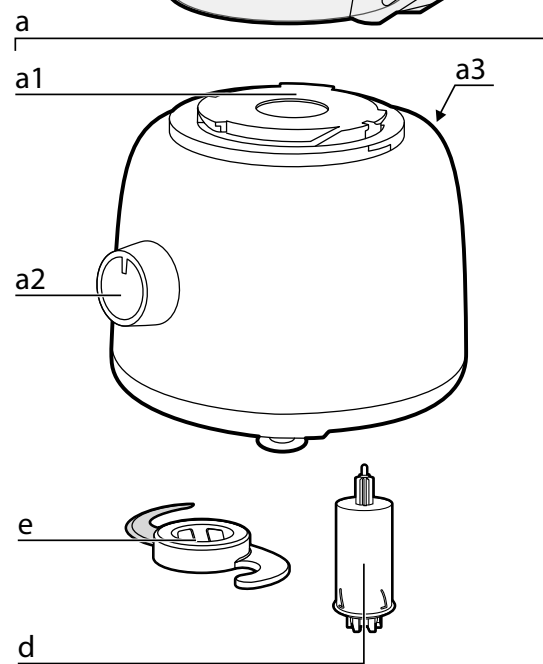
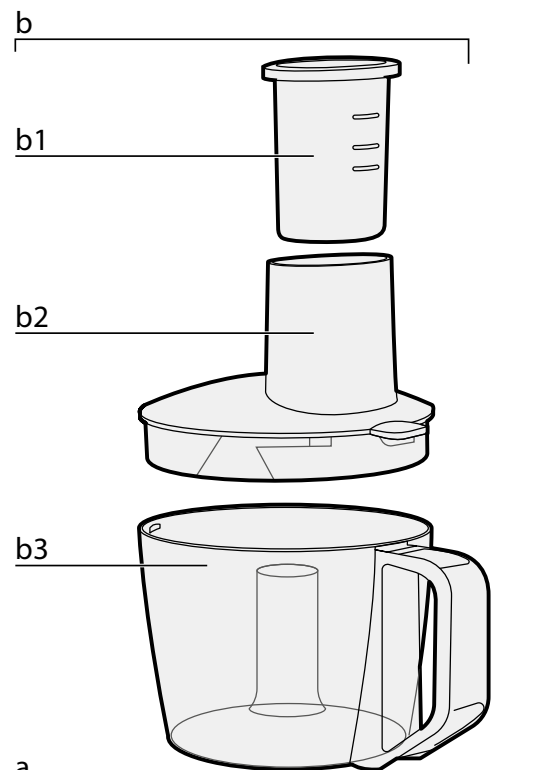

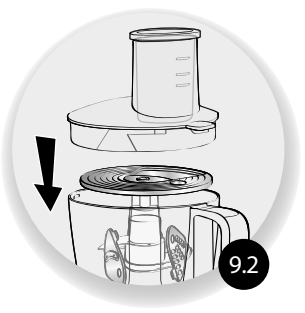
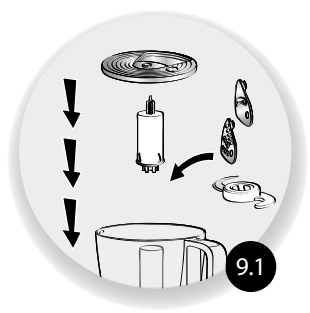
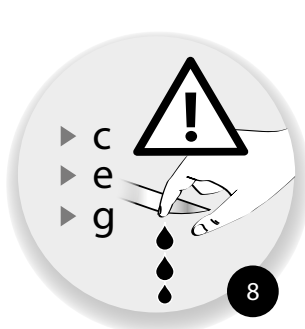
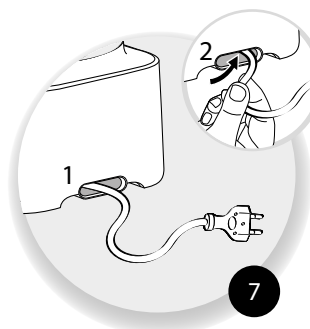
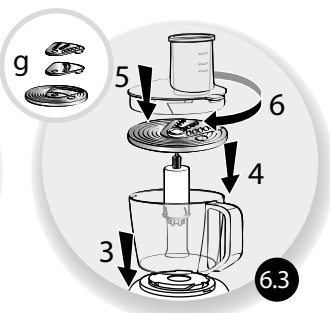
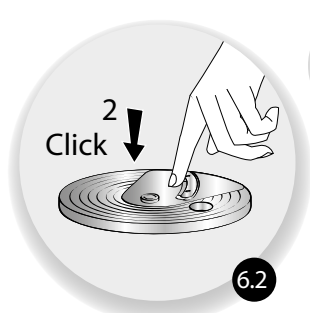
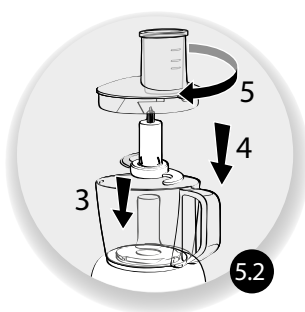
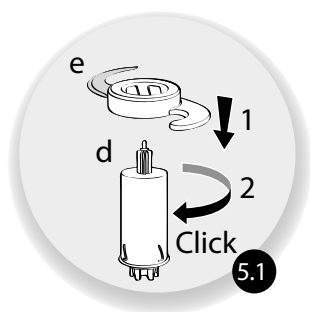









## Food Processor

Bruksanvisning - svenska .....	sida	XX - XX
Brugsanvisning - dansk .....	side	XX - XX
Bruksanvisning - norsk .....	side	XX - XX
Käyttöohjeet - suomi .....	sivu	XX - XX
Instructions of use - english.....	page	XX - XX



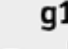



		 		 ② + Pulse
		300g max	30s	
		0,8L	40s	
		 375g  225g	1min	
		 310g  190g	30s	
		800g	1min30 ▶ 2min	
		0,8L	1min ▶ 1min30	
 		300g	30s	②
				①



### **Var rädd om miljön!**

- ① Din apparat innehåller olika material som kan återanvändas eller återvinnas.
- ➔ Lämna den på en återvinningsstation eller på en auktoriserad serviceverkstad för omhändertagande och behandling.

Information om din garanti finns på **obhnordica.se**

### **TEFAL - OBH Nordica Group AB**

Löfströms Allé 5

172 66 Sundbyberg

Tel 08-629 25 00

[www.obhnordica.se](http://www.obhnordica.se)

### **Teknisk data**

OBH Nordica TYPE FO342EN0

220-240V ~, 50-60 Hz

600 W



Rätt till löpande ändringar förbehålles.





### **Vi skal alle være med til at beskytte miljøet!**

- ① Apparatet indeholder mange materialer, der kan genvindes eller genbruges.
- ➔ Bring det til et specialiseret indsamlingssted for genbrug eller et autoriseret serviceværksted, når det ikke skal bruges mere.

Find information om din garanti på **obhnordica.dk**

### **Groupe SEB Danmark A/S**

**2750 Ballerup**

**Visiting address: Tempovej 27**

**Phone: +45 43 350 350**

**Direct: +45 43 350 367**

**www.obhnordica.dk**

### **Tekniske data**

OBH Nordica TYPE FO342EN0

220-240 V ~, 50-60 Hz

600 W



Ret til løbende ændringer og forbedringer forbeholdes.







### **Tenk miljøvern!**

- ① Apparatet inneholder verdifullt materiale som kan gjenvinnes eller resirkuleres.
- ➔ Lever det ved et lokalt kommunalt gjenvinningsanlegg.

Finn informasjon om din garanti på **[www.obhnordica.no](http://www.obhnordica.no)**

**Groupe SEB Norway AS**  
**Philip Pedersens vei 20, 3. etage**  
**1366 Lysaker**  
**Norway**  
**Telephone: +47 22 96 39 30**  
**[www.obhnordica.no](http://www.obhnordica.no)**

### **Tekniske data**

OBH Nordica TYPE FO342ENO  
220-240V ~, 50-60 Hz  
600 W



Retten til fortløpende endringer forbeholdes.





### Huolehtikaamme ympäristöstä!

- ① Laitteesi on varustettu monilla arvokkailla ja kierrätettävillä materiaaleilla.  
➔ Toimita laitteesi keräyspisteeseen tai sellaisen puuttuessa vaikka valtuutettuun huoltokeskukseen, jotta laitteen osat varmasti kierrätetään.

Tuotettasi koskevat takuutiedot löydät osoitteesta **www.obhnordica.fi**

**Groupe SEB Finland OY**  
**Bolero Business Park, Atomitie 2**  
**00370 Helsinki**  
**Finland**  
**Puh. (09) 894 6150**  
**www.obhnordica.fi**

### Tekniset tiedot

OBH Nordica TYPE FO342ENO  
220-240 V ~, 50-60 Hz  
600 W



Oikeus muutokseen pidätetään.

## SAFETY INSTRUCTIONS

- Please read the instructions for use carefully before using your appliance for the first time and retain them for future reference: the manufacturer cannot accept any liability for non compliant appliance use.
- This appliance is not intended for use by persons (including children) with reduced physical, sensory or mental capacities, or lack of experience and knowledge, unless they have been given supervision or instruction concerning use of the appliance by a person responsible for their safety.
- Children should be supervised to ensure that they do not play with the appliance.
- Do not use the appliance if the power cord or plug is damaged. The power cord must be replaced by the manufacturer, its aftersales service or similarly qualified persons in order to avoid danger.
- Always disconnect the appliance from the supply if it is left unattended and before assembling, disassembling or cleaning.
- Switch off the appliance and disconnect from supply before changing accessories or approaching parts that move in use.
- **Caution:** you may injure yourself if you use the appliance incorrectly.
- Always use the push sticks to guide the food in the tubes, never use your fingers, forks, spoons, knives or any other object while your appliance is operating.
- Do not allow long hair, scarves, ties, etc. dangle over the accessories when in operation.
- Do not use this appliance to blend or mix non-food items.
- When emptying the bowls, assembling and disassembling the accessories, and cleaning, handle the chopping knife, the blender knife, the mini-chopper blades, the grinder knife, the chopper head knife and the vegetable cutting discs (according to model) with care: they are extremely sharp. The chopping knife is to be removed by its drive before emptying the contents from the bowl.
- Assembly, disassembly and cleaning of the grater discs (according to model) shall not be done by children, due to presence of sharp blades on the other side of the disc.
- Do not operate your appliance when empty.
- Do not use the mixer bowl (according to model) without ingredients, without its cover or only with dry products, and do not

pour boiling liquids (over 80°C/176°F) into it.

- Never place your fingers or any other object not intended for this function in the blender jug when the appliance is running.
- Always pour the liquid ingredients into the blender jug first, before adding the solid ingredients.
- Never touch moving parts, wait until appliance has come to a complete stop before removing accessories.
- Use you appliance on a flat, clean and dry surface.
- Always unplug your appliance from the mains as soon as you have finished using it (even in the event of a power outage) and when you clean it.
- With Juice extractor accessory (according to model): do not use the appliance if the rotating sieve or the protecting cover is damaged or has visible cracks.
- Be careful if hot liquid is poured into the food processor or blender as it can be ejected out of the appliance due to a sudden steaming.
- Do not use the accessories as recipients (for freezing-cooking-hot sterilisation, microwave).
- Do not use the mixer or the emulsifying disc to prepare heavy doughs.
- This product has been designed for domestic use only and for altitudes of up to 2000 m.
- This appliance is not intended to be used in the following applications, and the guarantee will not apply for :
  - Staff kitchen areas in shops, offices and other working environments;
  - Farm houses;
  - By clients in hotels, motels and other residential type environments.
  - Bed and breakfast type environments.
- Refer to the instructions to obtain the appropriate operating time and speed settings for each accessory.
- Refer to the instructions for correct fitting and assembly of your accessories.
- Refer to the instructions for initial and regular cleaning of surfaces in contact with foodstuff, and for cleaning and maintenance of your appliance.

## **FOR EUROPEAN MARKETS ONLY**

- For all accessories except multiwire whisk, emulsifying disk, citrus press and grater discs (according to model): this appliance shall not be used by children. Keep the appliance and its cord out of reach of children.
- Children shall not play with the appliance.
- This appliance may be used by persons with reduced physical, sensory or mental capabilities, or whose experience or knowledge is not sufficient, provided they are supervised or have received instruction to use the device safely and understand the dangers.
- The multiwire whisk, emulsifying disk, the citrus press and the grater discs (according to model) can be used by children aged from 8 years and above if they have been given supervision or instruction concerning use of the appliance in a safe way and if they understand the hazards involved.
- Cleaning and user maintenance shall not be made by children unless they are aged from 8 years and above and supervised; Keep the appliance and its cord out of reach of children aged less than 8 years.

## **REGARDING ELECTRICAL SUPPLY**

- Check that the voltage of your appliance matches that of your electrical installation.
- Any incorrect connection invalidates the warranty.
- Do not immerse the appliance, the power cord or the plug in water or any other liquid.
- Do not leave the power cord with in the reach of children or close to or in contact with the hot parts of your appliance, close to a source of heat or on a sharp edge.

## **AFTER SALES SERVICE**

- Any operations other than the usual cleaning and maintenance operations carried out by the customer must only be carried out by an approved service centre (see list in the service booklet).
- For your safety, only use accessories and spare parts that are suited to your appliance.
- Do not use the appliance if it is not working properly or if it has been damaged. In this case, contact an authorised service centre.

**CAUTION:** the safety precautions are part of the appliance. Read them carefully before using your new appliance for the first time. Keep them in a place where you can find and refer to them later on.

## RECOMMENDATIONS FOR USE

- The recommended operating speed is engraved on the accessories (g, e).

## ROUGH CHOPPING SMALL QUANTITIES (DEPENDING ON MODEL)

ACCESSORIES USED: Assembled chopper

- Chop in a few seconds by pulsing: rice, etc.

Model 700W - 800W: Quantity / max time: 95g / 4s

Model 500W - 600W: Quantity / max time: 60g / 4s

## CLEANING

- Unplug the appliance.
  - For easier cleaning, rinse the accessories quickly after use.
  - Wash and dry the accessories: They can all go into the dishwasher, be immersed or be washed under running water, excepting the motor unit (a). Wipe the latter using a damp sponge.
  - The accessory blades are extremely sharp. Handle them with care.
- Tip: Should your accessories look stained by foods such as carrots or oranges, rub them with a cloth drenched in vegetable oil, then clean as usual.

## WHAT TO DO IF YOUR APPLIANCE DOES NOT WORK

If your appliance does not work properly, check:

- that it is plugged in properly.
- that each accessory is properly screwed on.

Your appliance still doesn't work? Go to an authorized service centre.

## ACCESSORIES

You can personalize your appliance by purchasing any of the following accessories at your usual reseller store or at one of our authorized service centres:

- **b:** Chopper bowl
- **d:** Common spindle
- **g:** Vegetable slicer set:
- **g1:** Grating cartridge
- **g2:** Slicing cartridge
- **g4:** Cartridge stand

Attention: In order to purchase any accessory for this appliance, you must necessarily present the instructions manual provided with it or the appliance itself.



### Environment protection first!

- ① Your appliance contains valuable materials which can be recovered or recycled.
- ➔ Leave it at a local civic waste collection point.

Information about your warranty is available at [www.obhnordica.com](http://www.obhnordica.com)

### TEFAL - OBH Nordica Group AB

Löfströms Allé 5

172 66 Sundbyberg

Phone 08-629 25 00

[www.obhnordica.com](http://www.obhnordica.com)

### Technical data

OBH Nordica TYPE FO342ENO

220-240V ~, 50-60 Hz

600 W



These instructions are subject to alterations or improvements.



Scan the QR code  
to receive our latest offers.