

INTRODUCING DOCTOR SQUISH

Visit www.squishymaker.com for detailed video demonstrations.

Doctor Squish is the most popular Squishy Maker in the world, and now you can make your very own squishies too!

Please remove all packaging before giving product to a child. Please retain packaging details for future reference.

Read the instructions before using the Squishy Maker. We recommend help from an adult for younger children and when using the Squishy Maker for the first time. Create new styles by mixing the content that comes with the Squishy Maker, or even better, use your own crazy stuff! HAVE FUN!

Doctor Squish Maker Station is only to be used with squishy balloons supplied. Practice with an empty squishy until you are comfortable with the Squishy Maker and the clips!

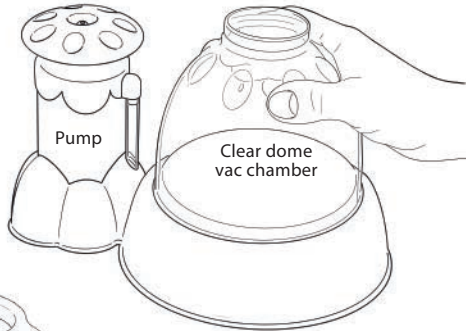

WARNING: CHOKING HAZARD - Small parts.
Not suitable for children under 3 years.

WARNING: CHOKING HAZARD - Small parts.
Children under 8 years can choke or suffocate on uninflated or broken balloons. Adult supervision required. Keep uninflated balloons from children. Discard broken balloons at once. Do not use close to ears or head. Misuse may cause damage to hearing or eyes. If your squishy bursts, clean up and dispose of in normal waste.

WARNING: STRANGULATION HAZARD - Long cord.
Risk of entanglement/strangulation due to long cord. Keep away from head and neck.

WARNING: Do not blow the balloon with the mouth, with the balloon pump only! Small parts maybe inhaled! Squishy Maker is only to be used with TPR squishies and balloons.

For powder: Keep away from eyes. If material accidentally enters the eye, rinse well with plenty of clean water. Seek medical attention if irritation persists. Do not ingest. Use of this product by children should be supervised by an adult. Keep out of reach of children when not in use.

WARNING! Do not heat or microwave squishies. Do not leave in direct sunlight. Do not leave in vehicle on a hot day. Please keep squishies in a bowl or container when not in use. Do not store in heat, cold, or direct sunlight. Do not get near sharp or jagged objects. Keep away from pets. Rough handling can puncture balloons. Do not throw squishies. Do not bite or pierce squishies. Do not eat or drink contents of the squishies. Throw away in trash, not in toilet or sink.



Made in China.
Complies with the safety requirements of ASTM F963 and EN71.



Manufactured by:
©2022 BOTI Global Ltd.,
Unit 404A-5, 4/F/ Tower 1,
South Seas Centre 75
Mody Road, TST, Kowloon,
Hong Kong.
www.bot-i.com.
questions@bot-i.com.

Under license from Seventowns Ltd.
Copyright ©2022 and co-developed
with BOTI Global Ltd.

1 First choose the size of the squishy to make. We recommend starting with the smaller size. Use the squishy supporter to make a small or medium squishy (just flip over the supporter to choose the size) and place it into the bowl of the Squishy Maker.

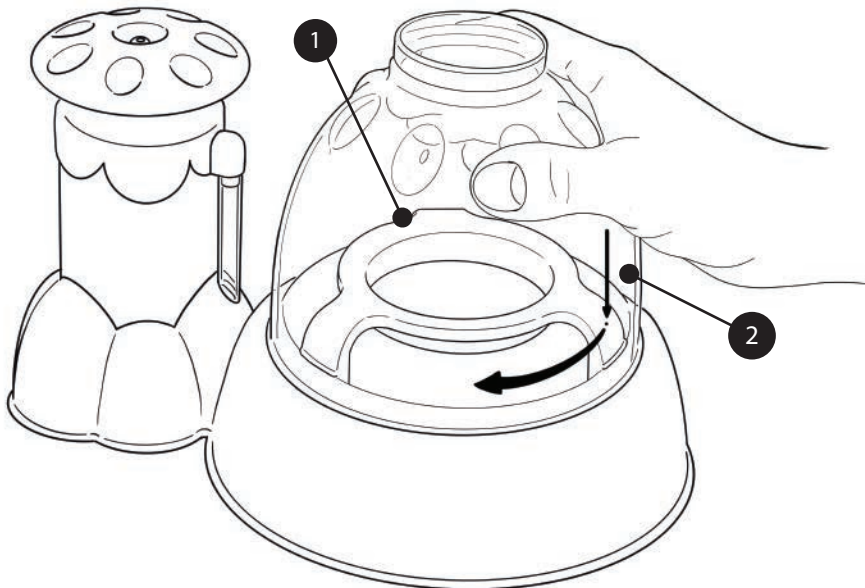

2 Place the clear dome onto the Squishy Maker and twist clockwise until it locks tightly closed.

3 Insert the squishy balloon into the dome and carefully stretch the neck of the squishy around the neck of the clear dome.

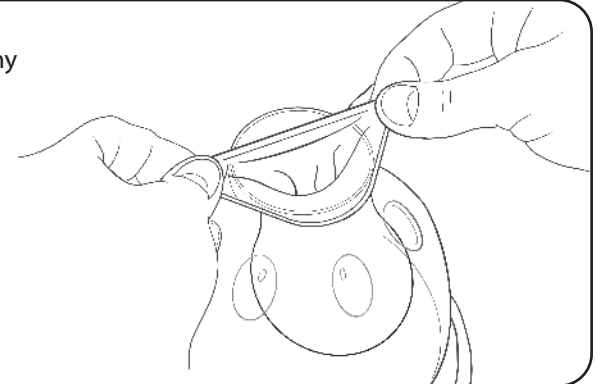

4 Start pumping and the squishy will "inflate" within the clear dome. Keep pumping until the squishy touches the support. If the squishy doesn't inflate, check if the clear dome is closed tight and the seal is clean.

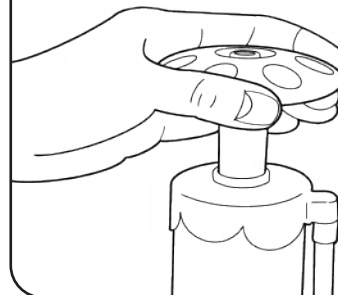

5 Use the 10 ml spoon to add the jelly powder to the inflated squishy inside in the dome. Add 1 spoon full for a small sized squishy and 1,5 spoons full for a medium sized squishy.



6 Add any extra content you want inside your squishy. Use the sparkles, confetti or any of your own items.

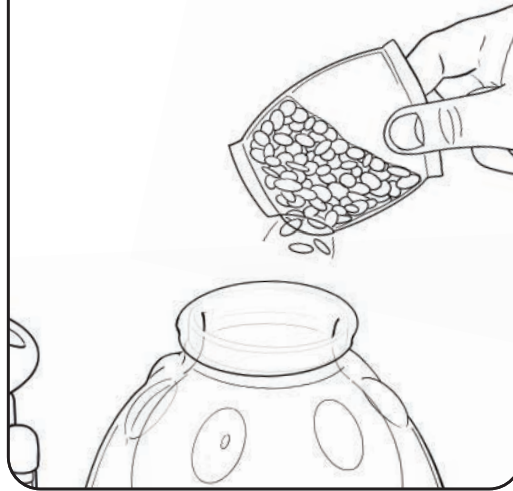

7 Now carefully fill the squishy with water, almost to the top, and gently stir the mixture.

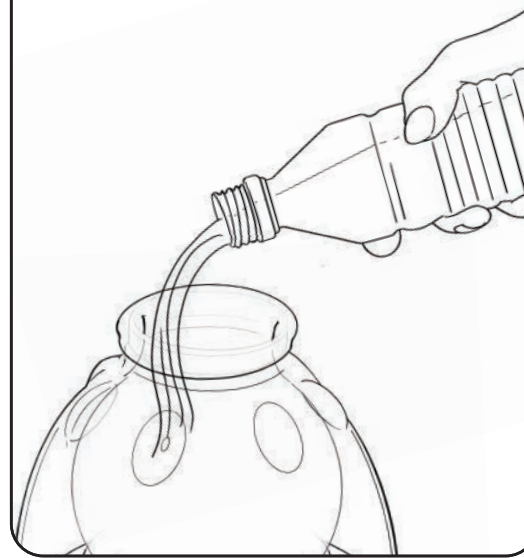

8 Put the bung into the neck of the squishy. Make sure it is in the right way around and don't let it fall inside! Hold the bung level with the edge of the chamber, carefully lift and roll the neck of the squishy up and it will snap into the slot around the bung and seal tight.

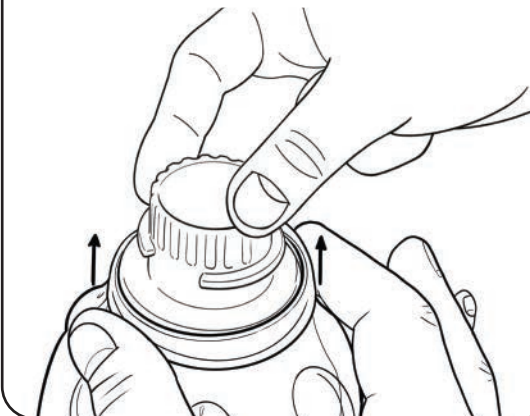

9 Now untwist the clear dome and carefully take the squishy out from the clear dome.

Gently twist the bung and neck of the squishy.

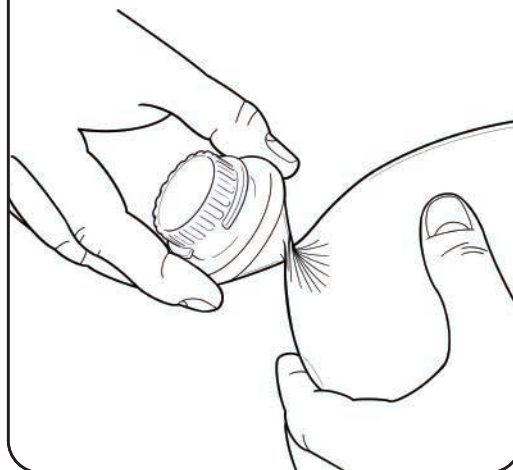

10 Put the special clip around the twisted neck of the squishy and carefully snap it shut. Now peel the neck of the squishy back and remove the bung.



**Check out the
instruction video**

For a step-by-step instruction
by Doctor Squish

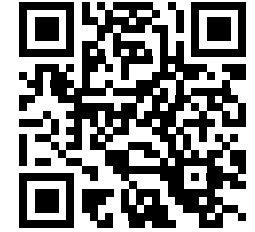

Enjoy your squishy!