

Manual for ASG4602

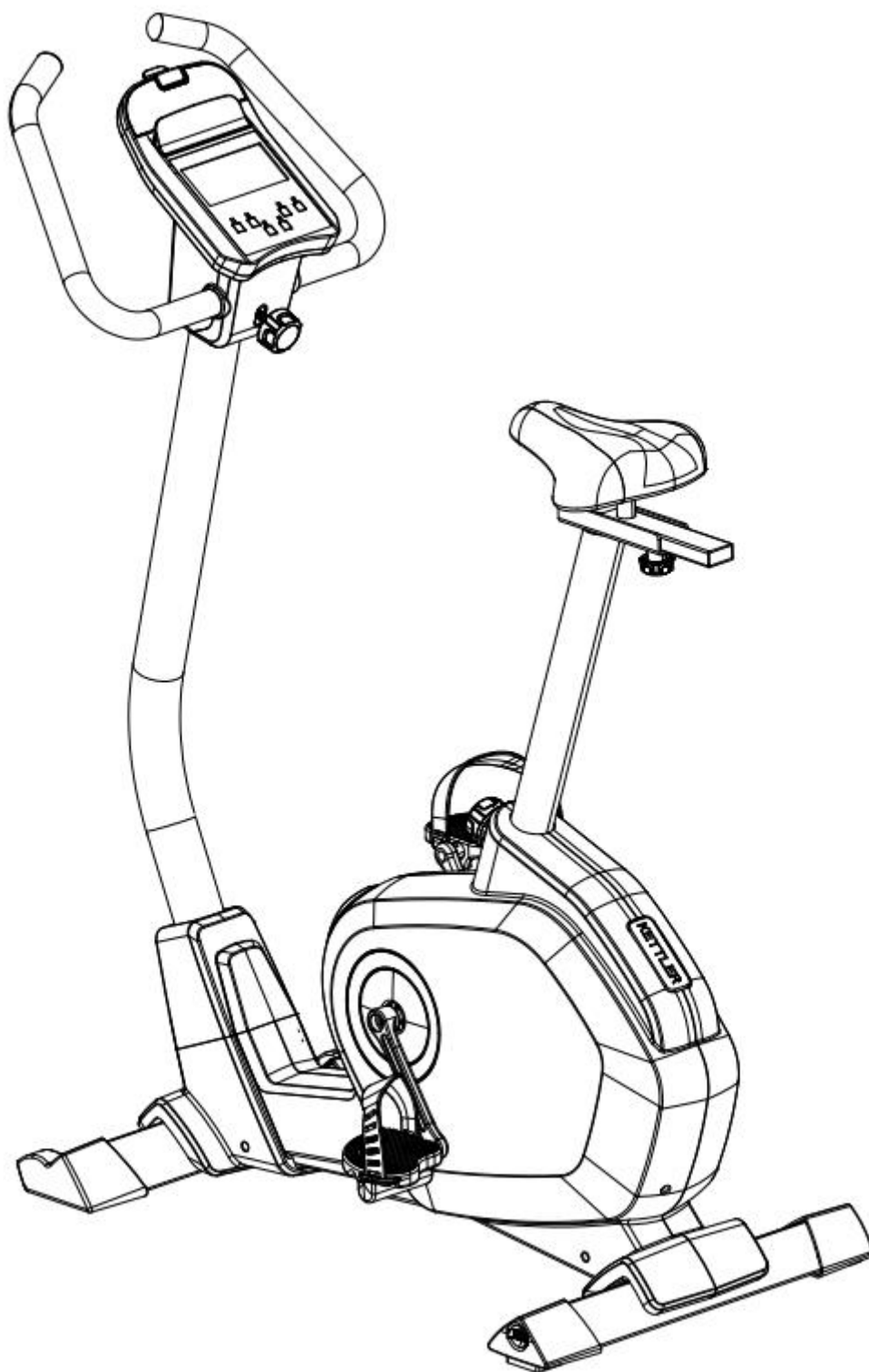

Exploded drawing

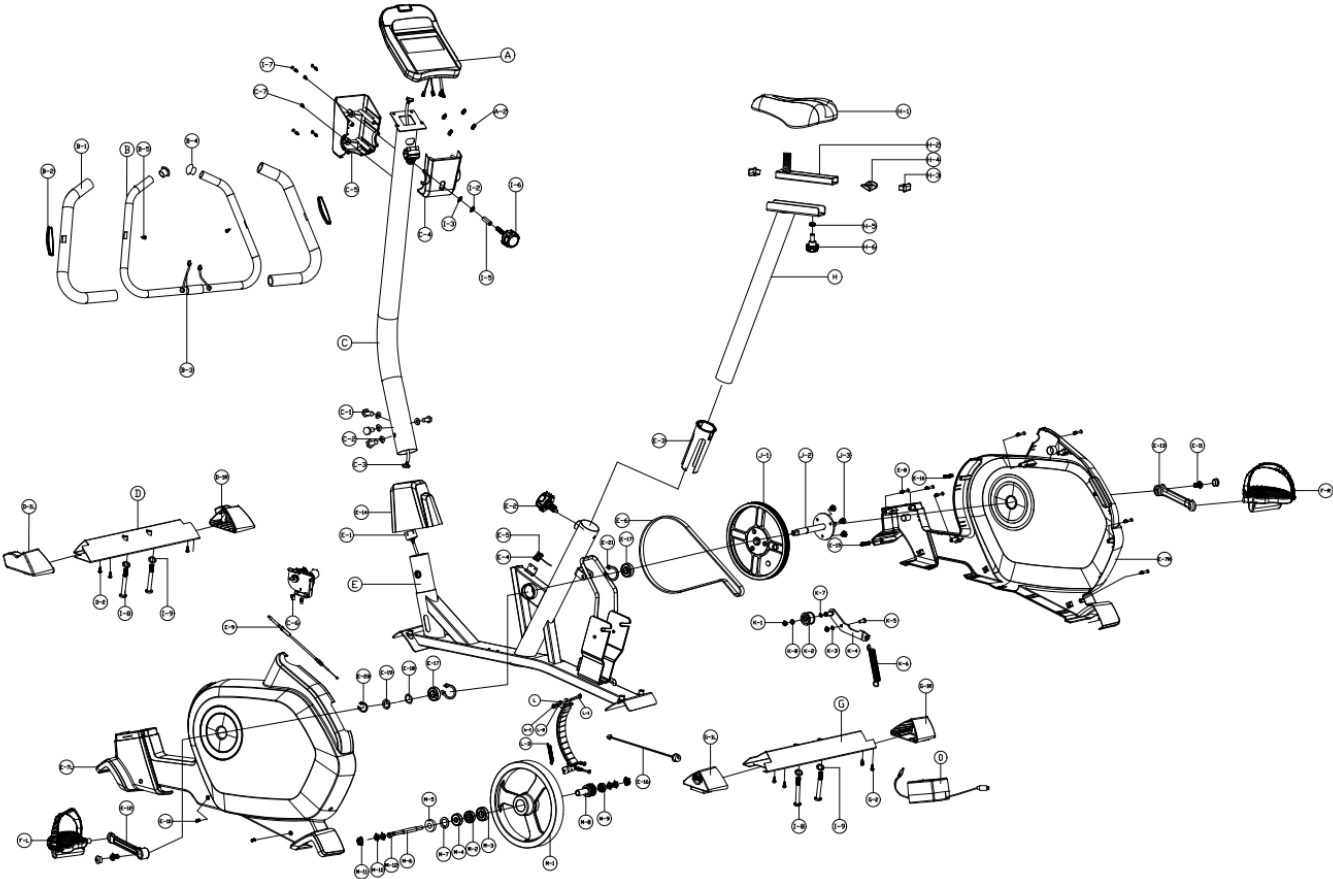



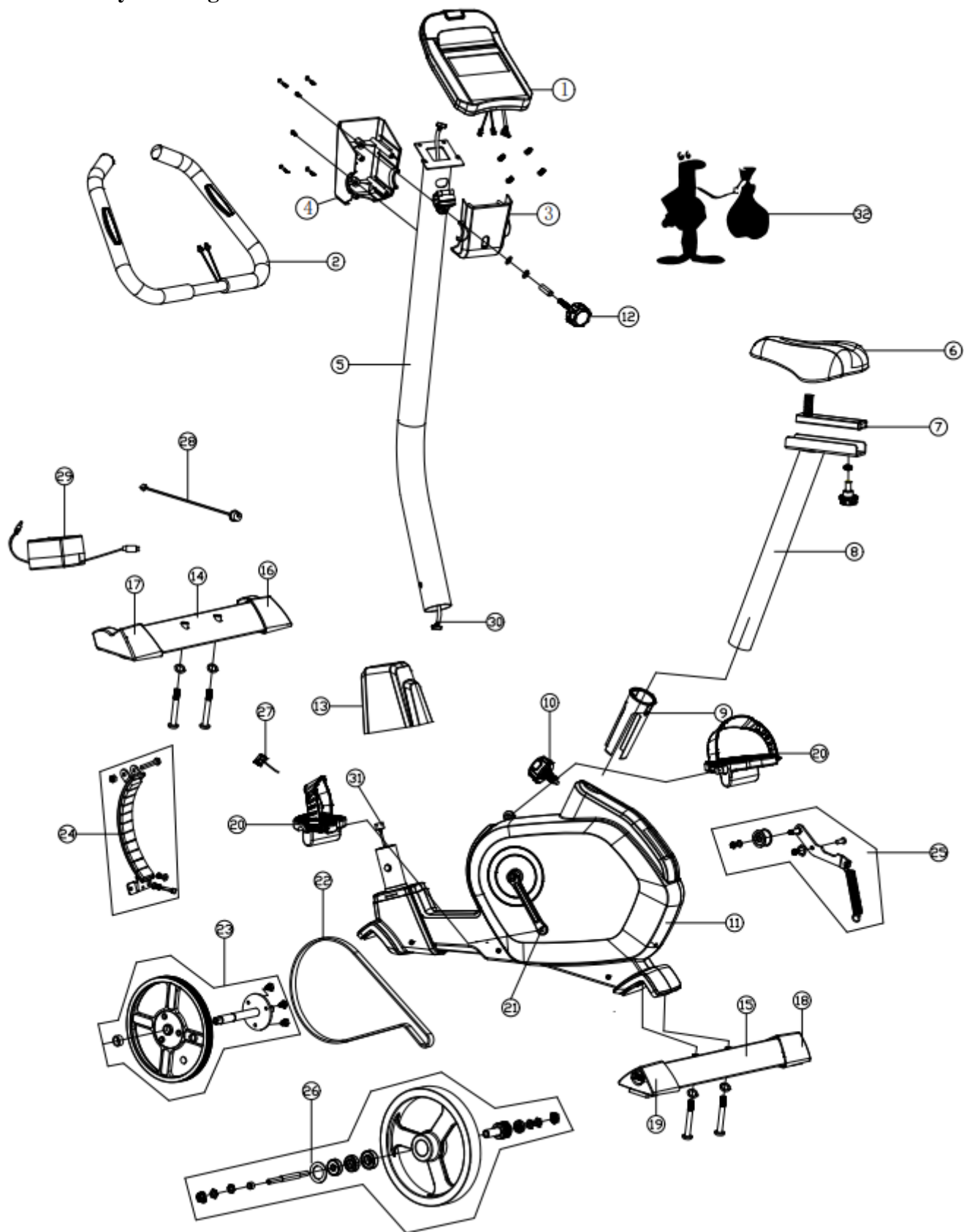





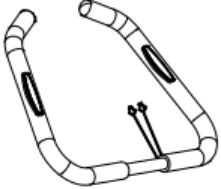

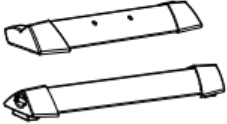



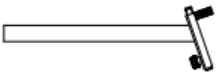
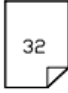

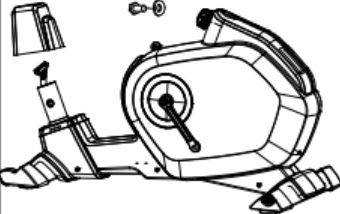
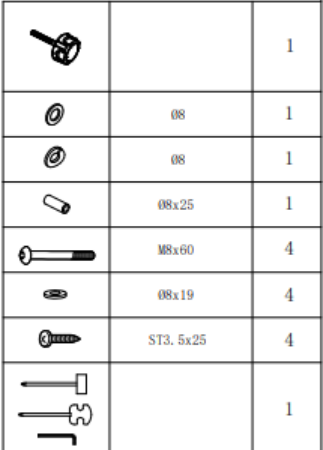

Pre-assembly drawing



NO	Description	NO	Description
1	Console	18	END CAP(R)
2	Handle bar	19	END CAP(L)
3	FRONT DECORATION COVER	20	Pedal

4	REAR DECORATION COVER		21	RL leg
5	CENTRAL SUPPORT TUBE		22	BELT
6	Seat		23	DRIVING WHEEL
7	MOVING BASEMENT		24	MAGNETIC HOUSING
8	SADDLE SUPPORT TUBE		25	PRESSING PLATE
9	PLASTIC PIPE		26	MAGNETIC WHEEL
10	KNOB		27	Sensor box
11	MAIN FRAME		28	DC cable
12	KNOB		29	Adaptor
13	CENTRAL SUPPORT TUBE COVER		30	SENSOR WIRE
14	FRONT STABILIZER		31	CABLE
15	REAR STABILIZER		32	HARDWARE CARD KIT
16	END CAP(R)			
17	END CAP(L)			

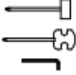
	1		1
	1		1
	1		
	1		
	1		
	1		
	2xM5+16		
	4xM5+10		
	1		
			1
			08
			08
			08x25
			M8x60
			08x19
			ST3. 5x25
			1

NO	Description	Material	SPEC.	Q'ty	NO	Description	Material	SPEC.	Q'ty
A	Console			1	H	Seat post			1
					H-1	seat			1
A-2	Screw	35	M5*10	4	H-2	End cap		PP	2
B	Handle bar		φ 22.2*2T*1194L	1	H-3	MOVING BASEMENT			1
B-1	Spong		540L	2	H-4	Bolt	Q235	7/16"	1
B-2	Handle pulse	34B		2	H-5	Washer	35	φ 12* φ 25*2T	1
B-3	Pulse wire		650L/500L	2	H-6	knob			1
B-4	Enc cap	PVC	7/8"STR	2					
B-5	screw	35	ST2.9*20L	2	I-2	Spring washer	35	φ 8*2T	2
C	CENTRAL SUPPORT TUBE	Q235	φ 60*1.8T*1060L	1	I-3	washer	35	φ 8* φ 12*1T	2
C-1	Screw	35	M8*20	4					
C-2	Wave washer	35	φ 8* φ 19*2T	4	I-5	Bush		φ 8* φ 12*35L	1
C-3	Sensor wire		1150L	1	I-6	knob			1
C-4	FRONT DECORATION COVER	ABS		1	I-7	SCREW		ST2.9*16L	4
C-5	Rear DECORATION COVER	ABS		1	I-8	SCREW	35	M8*60L	4
C-6	Screw	35	M6*18L	2	I-9	WASHER	35	φ 8* φ 19*2T	4
C-7	Screw	35	M5*16L	2	J-1	DRIVING WHEEL		φ 260*6J	1
D	FRONT STABILIZER	Q235		1	J-2	AXLE		φ 17*188	1
D-1L	End cap(L)	PP		1	J-3	SCREW	35	M8*12L	3
D-1R	End cap(R)	PP		1	K-1	NUT		M8*7T	2
D-2	Screw	35	ST2.9*18	4	K-2	BEARING HOUSING			1
E	Main frame	Q235		1	K-3	Washer	Q235	φ 8* φ 22*1T	2
E-1	CABLE		650L	1	K-4	PRESSING PLATE			1
E-2	knob		M16*22	1	K-5	Screw		M8*20L	1
E-3	PLASTIC PIPE	PP	φ 60	1	K-6	SPRING	65Mn	φ 16* φ 2.5	1
E-4	Sensor wire		230L	1	K-7	Washer	35	φ 10.2* φ 13*0.3T	1
E-5	screw	35	M3*8L	1	K-8	washer	35	φ 8* φ 14*2T	1
E-6	BELT		430J6	1	L	MAGNETIC HOUSING			1
E-7L	Chain cover(up)	ABS		1	L-1	Washer			1
E-7R	Chain cover(low)	ABS		1	L-2	SCREW		M8*55L	1
E-8	screw	35	ST3.9*50	7	L-3	SPRING			1
E-9	wire		230L	1	M-1	FLY WHEEL		φ 280*32W*8KG	1
E-10	Screw	35	3/16"*3/4"	6	M-2	BEARING		6003	1
E-11	Screw	35	M8*20L	2	M-3	Bearing		6300	1
E-12	Leg L		9/16"	1	M-4	Bearing		6203	1
E-13	Leg R		9/16"	1	M-5	One way bearing		φ 35*17	1
E-14	COVER	ABS		1	M-6	axle		3/8"-26*130L	1
E-15	Shell bar	ABS		2	M-7	washer	35	φ 30* φ 34*30.8T	1
E-16	Shell bar	ABS		2	M-8	Bearing housing		φ 34*8J	1
E-17	bearing		6203	2	M-9	bearing		6000	1
E-18	washer		φ 17.5* φ 25*0.3T	1	M-10	screw			2
E-19	Flat washer	35	φ 17.5* φ 25*0.3T	1	M-11	nut			2

E-20	C clip			2	M-12	bush		9mm	1
E-21	C clip			2	O	adaptor			1
F-L	Pedal L			1	P	motor			1
F-R	Pedal R			1					
G	REAR STABILIZER			1					
G-1L	END CAP L	PP		1					
G-1R	END CAP R	PP		1					
G-2	SCREW	35	ST3.9*10L	4					

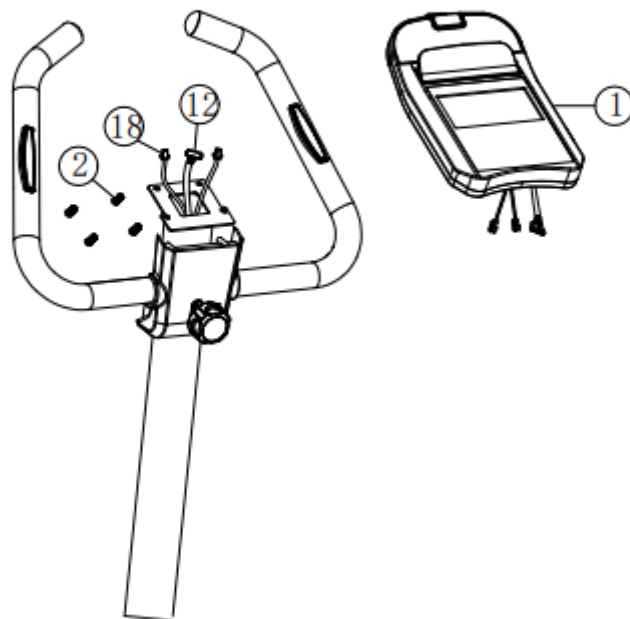
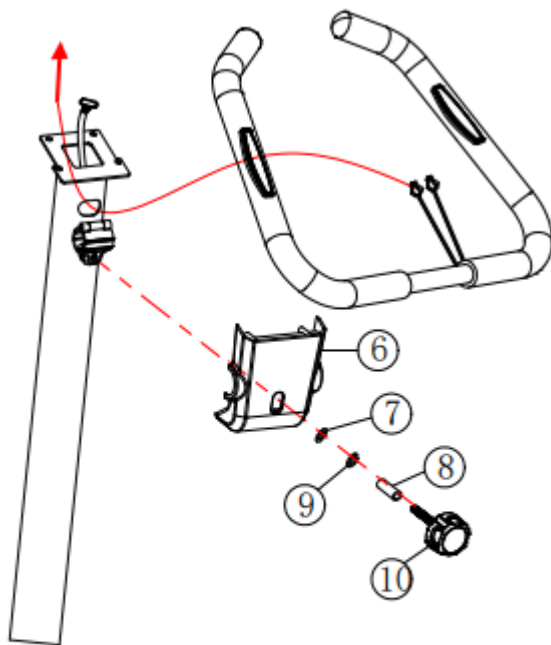

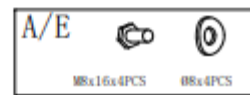
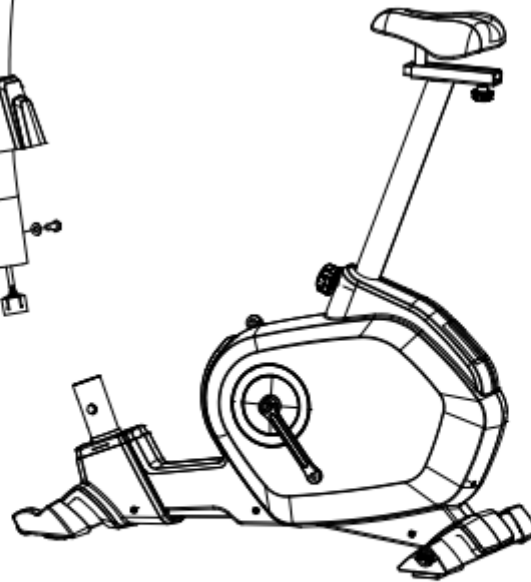
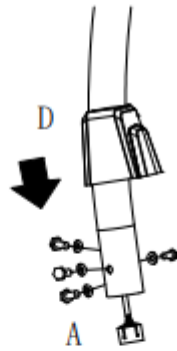
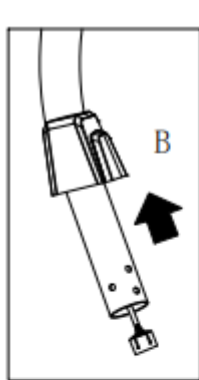
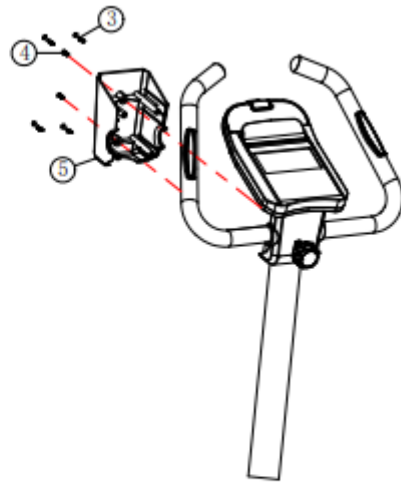

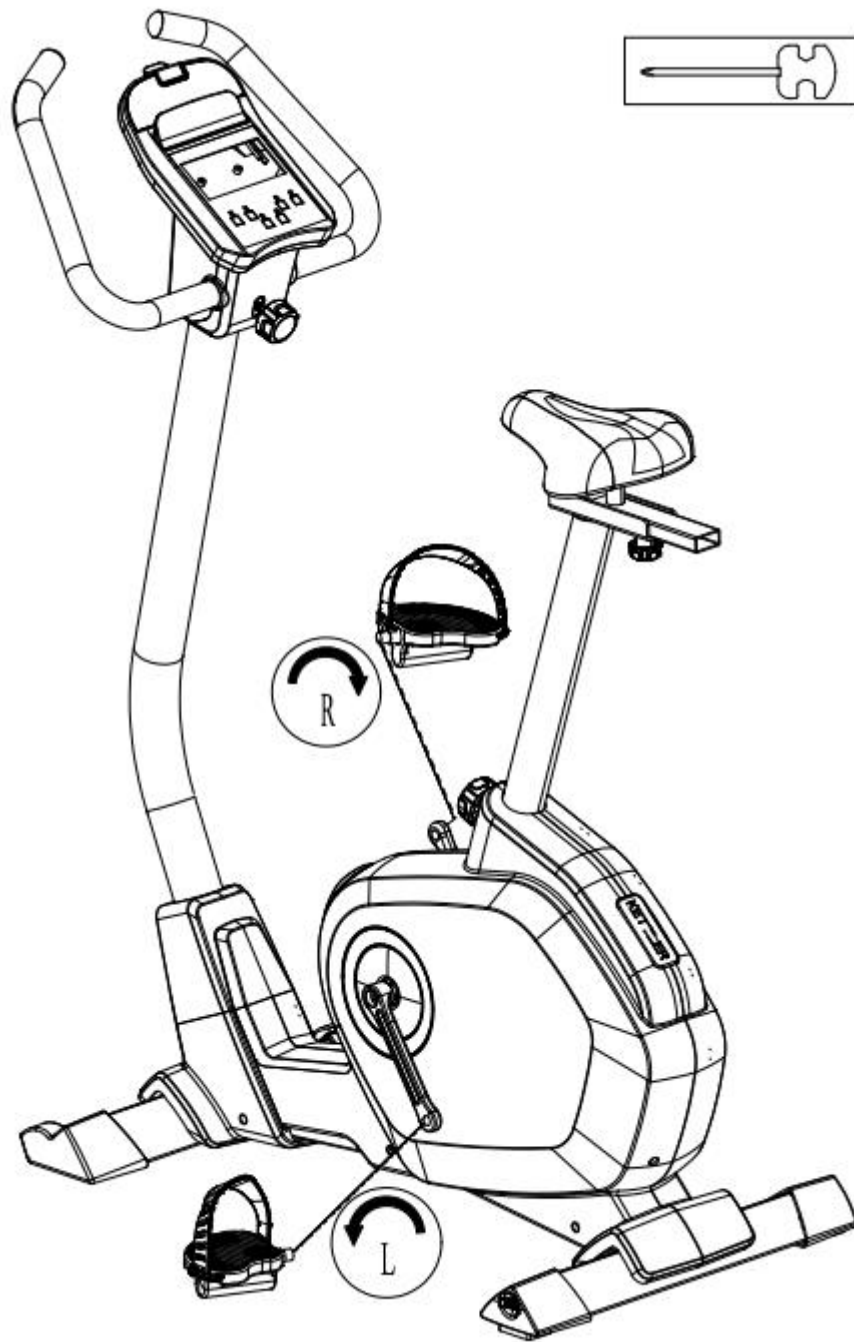

*** IMPORTANT SAFETY INFORMATION ***

PLEASE FOLLOW THE SAFETY RULES BELOW TO AVOID INJURY AND/OR ACCIDENTS.

1. KEEP THE BIKE AWAY FROM THE ACCESS OF CHILDREN, DO NOT ALLOW THE CHILDREN TO BE AROUND WHEN USING THE MACHINE.
2. DO NOT RIDE THE BIKE STANDING UP.
3. DO NOT RIDE WHILE WEARING LOOSE ROBES, LOOSE PANTS OR SKIRTS.
4. ALWAYS WEAR A RUBBER SOLE SHOES OR TENNIS SHOES WHEN RIDING.
5. PLACE THE BIKE ON A SMOOTH HARD SURFACE.
6. THE USER'S MAX WEIGHT IS 100KGS.
7. THE BRAKING SYSTEM OF THE BIKE IS SPEED DEPENDMENT.
8. THE FIELD OF APPLICATION IS FOR HOME USE.
9. BEFORE EACH USE, MAKE SURE THAT ALL OF THE FASTENERS ON THE UNIT ARE TIGHTENED SECURELY. IF HAVE DEFECTIVE, KEEP THE EQUIPMENT OUT OF UNTIL REPAIR.
10. THE BRAKE PAD IS MOST SUSCEPTIBLE TO WEAR. BEFORE USE, MAKE SURE IT HAVE FUNCTION.
11. THE SAFETY LEVEL OF THE EQUIPMENT CAN BE MAINTAINED ONLY IF IT IS EXAMINED REQLARLY FOR DAMAGE AND WEAR.
12. THIS BIKE NOT SUITS FOR THERAPEUTIC USE.

Manual til ASG4602

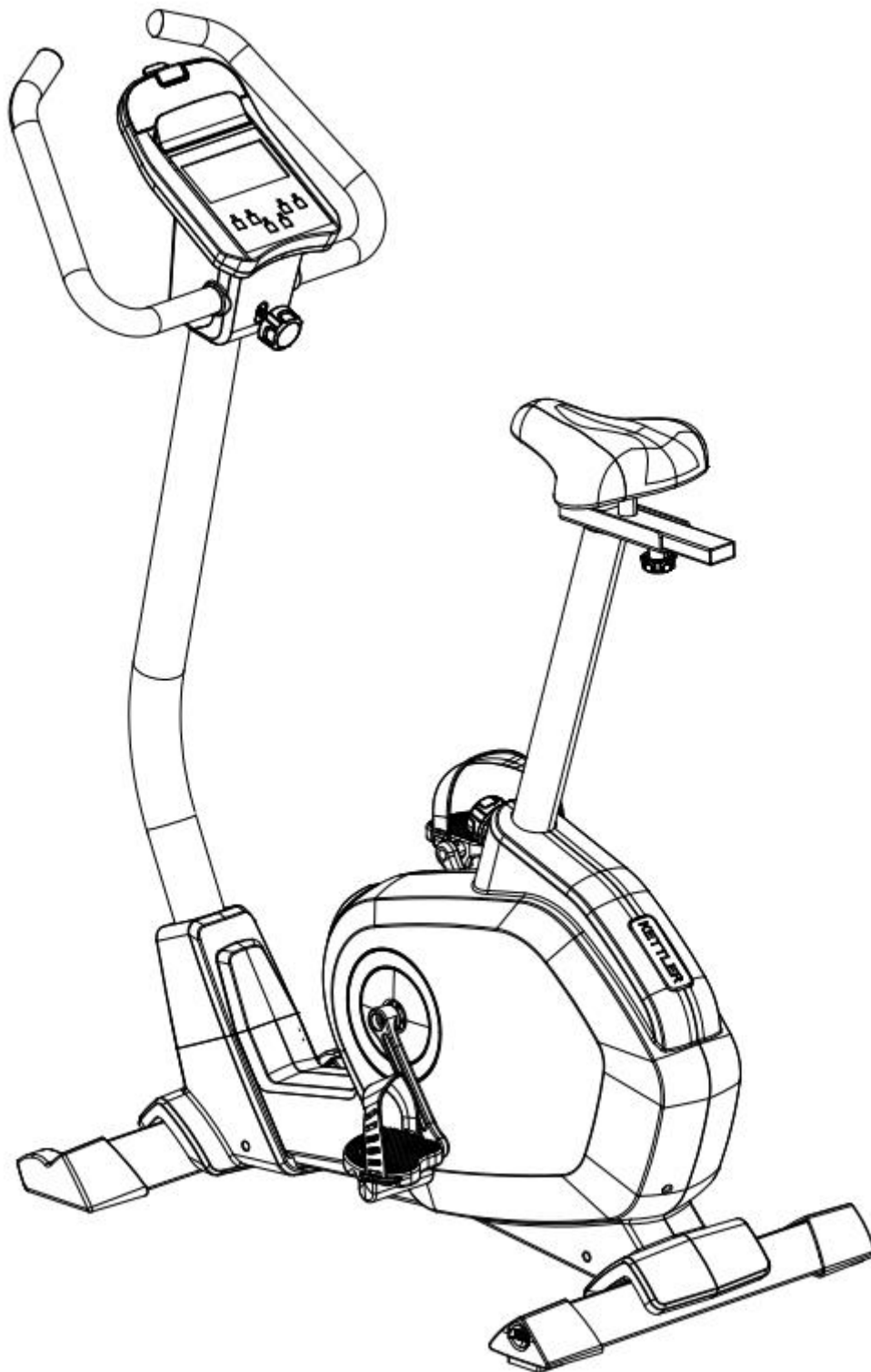

Eksploderet tegning

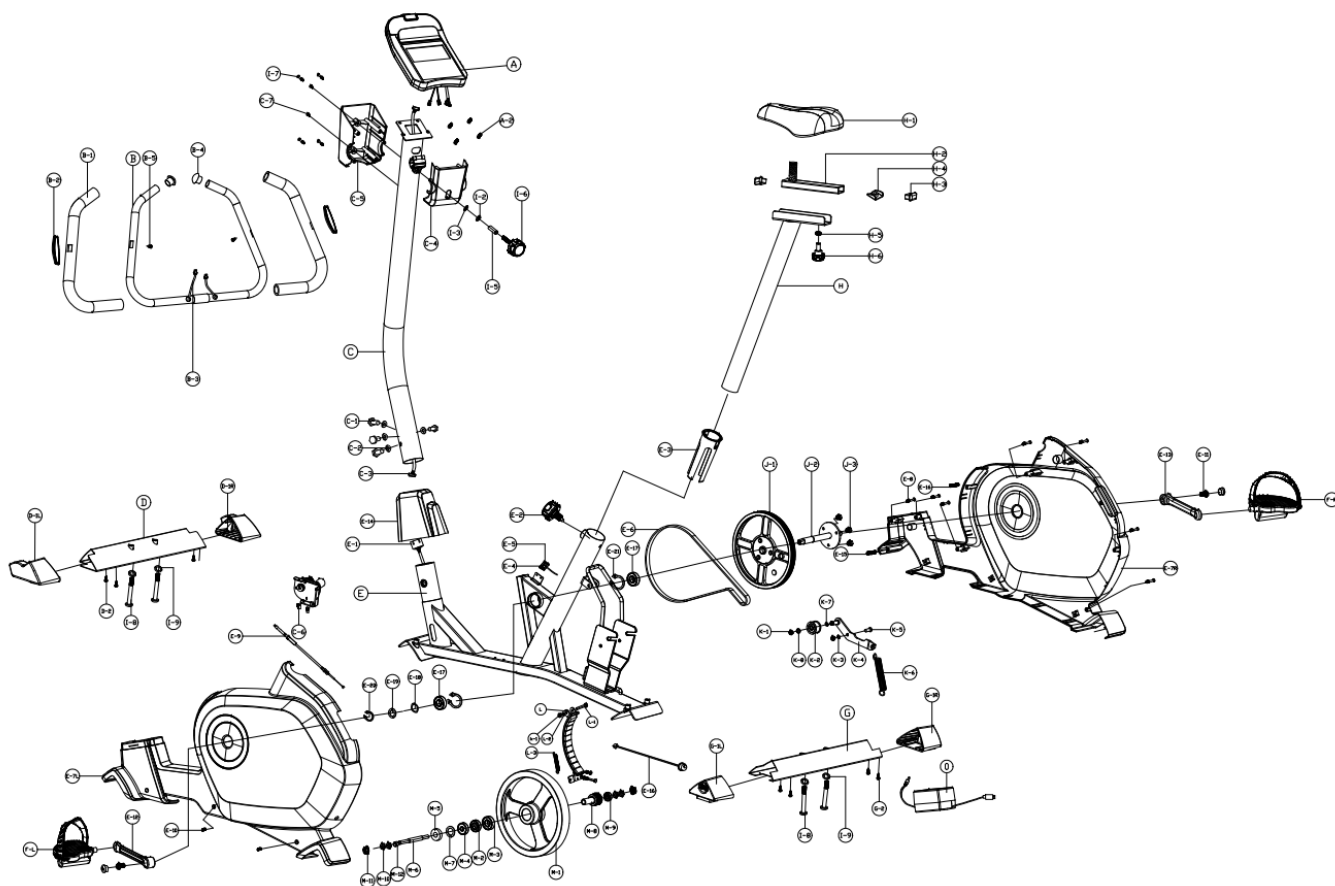

Formonteringstegning

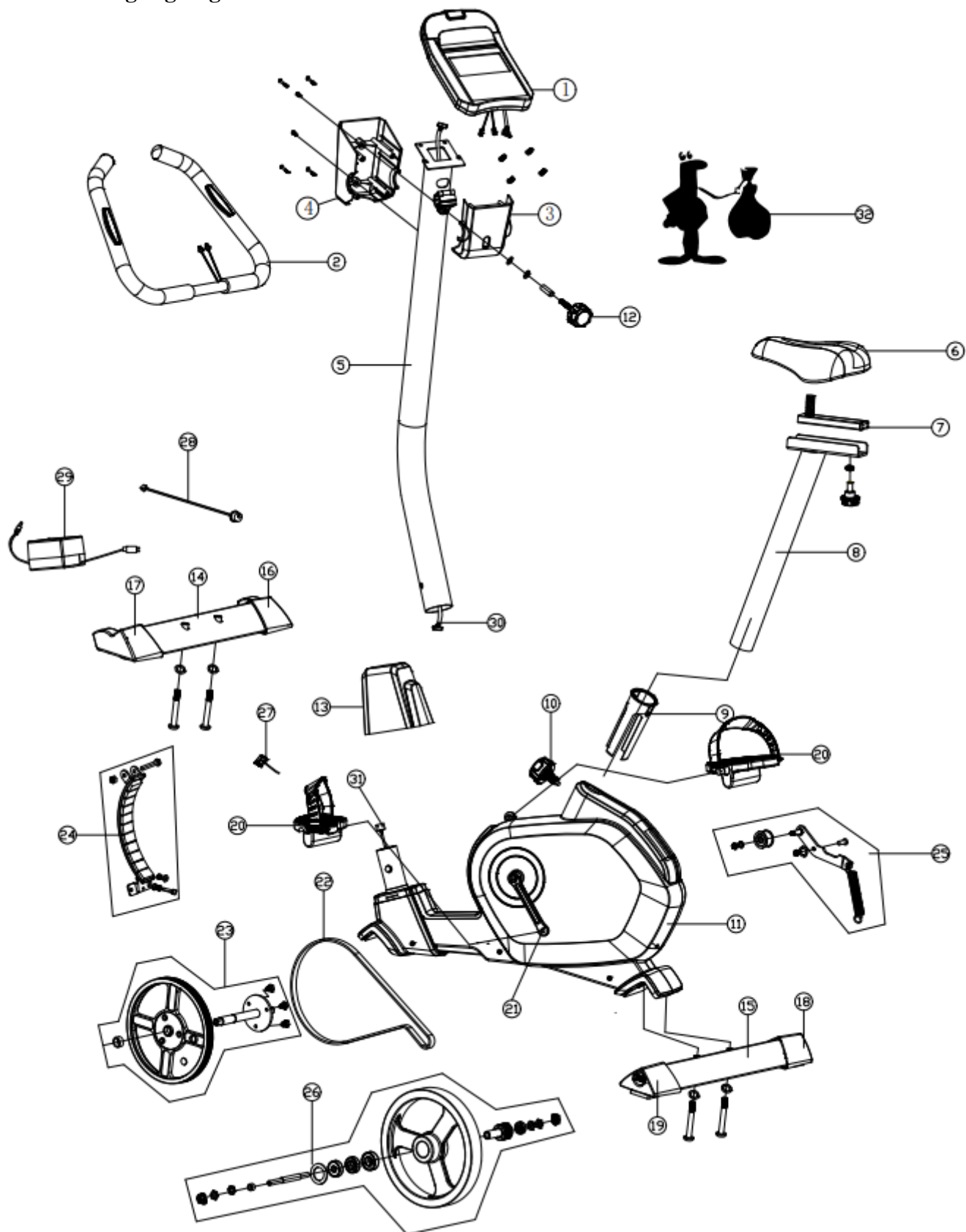

Nr	Beskrivelse	Nr	Beskrivelse
1	Konsol	18	ENDEHÆTTE (H)
2	H åndtag	19	ENDEHÆTTE (V)
3	FORSIDEDEKORATIONSOVERSLAG	20	Pedal

4	BAGSTE DEKORATIONS DÆKSLET		21	HV ben
5	CENTRAL STØTTERØR		22	BÆLTE
6	Sæde		23	DRIVHJUL
7	FLYTNING AF KÆLDER		24	MAGNETISK HUS
8	SADELSTØTTERØR		25	PRESSEPLADE
9	PLASTRØR		26	MAGNETISK HJUL
10	KNOP		27	Sensor box
11	HOVEDDRAMME		28	DC kabel
12	KNOP		29	Adapter
13	DÆKSLET TIL CENTRAL STØTTERØR		30	SENSORLEDNING
14	FRONTSTABILISATOR		31	Kabel
15	BAGSTE STABILISATOR		32	HARDWARE-KORTKIT
16	ENDEHÆTTE (H)			
17	ENDEHÆTTE (V)			

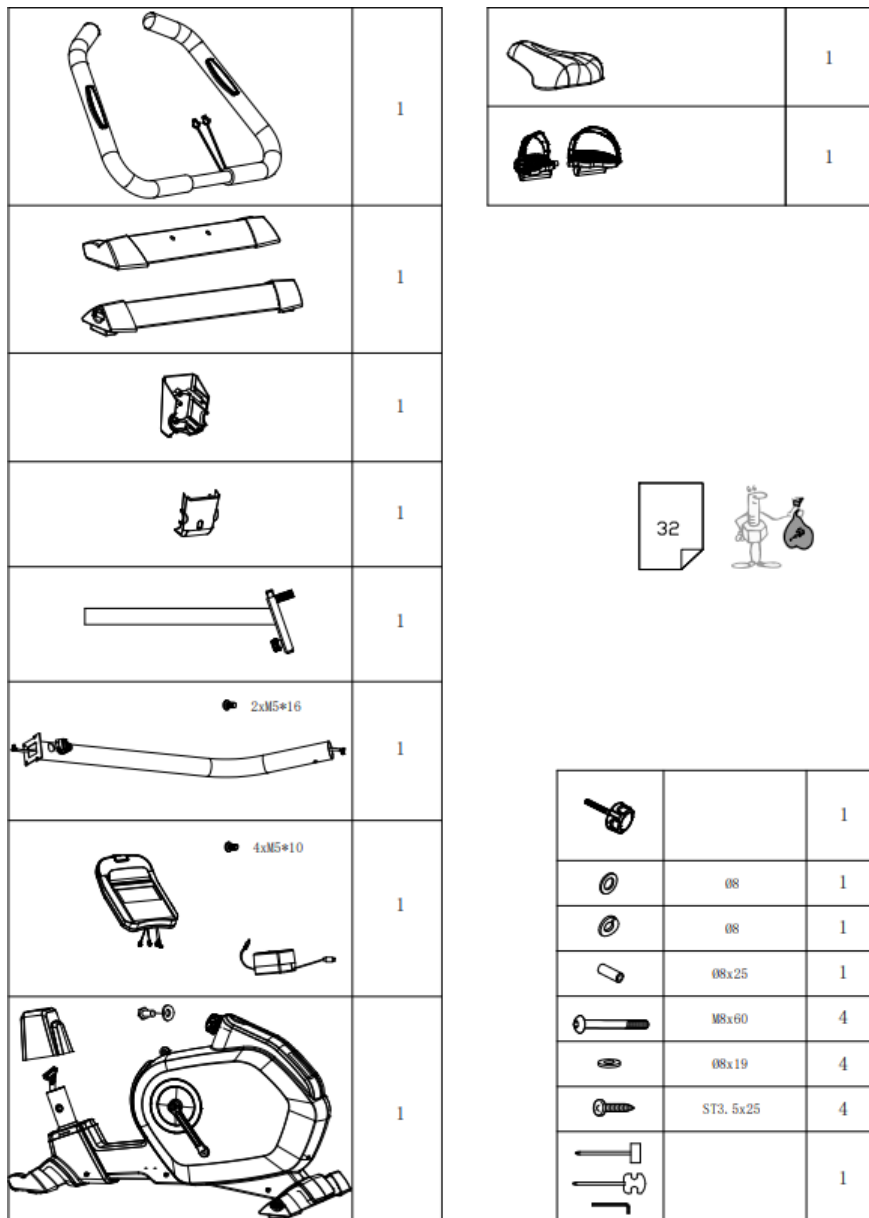

Nr	Beskrivelse	Materiale	SPEC.	Antal	Nr	Beskrivelse	Materiale	SPEC.	Antal
A	Konsol			1	H	Sadelpind			1
					H-1	Sadel			1
A-2	Skrue	35	M5*10	4	H-2	Endekappe		PP	2
B	Håndtag		φ 22.2*2T*1194L	1	H-3	FLYTNING KÆLDER	AF		1
B-1	Svamp		540L	2	H-4	Bolt	Q235	7/16"	1
B-2	Håndter puls	34B		2	H-5	Skive	35	φ 12* φ 25*2T	1
B-3	Pulstråd		650L/500L	2	H-6	knop			1
B-4	Enc-kapsel	PVC	7/8"STR	2					
B-5	Skrue	35	ST2.9*20L	2	I-2	Fjederskive	35	φ 8*2T	2
C	CENTRAL STØTTERØR	Q235	φ 60*1.8T*1060L	1	I-3	Skive	35	φ 8* φ 12*1T	2
C-1	Skrue	35	M8*20	4					
C-2	Bølgevaske	35	φ 8* φ 19*2T	4	I-5	Busk		φ 8* φ 12*35L	1
C-3	Sensorledning		1150L	1	I-6	Knop			1
C-4	FORSIDEDEKORATIONSOVERSLAG	ABS		1	I-7	Skrue		ST2.9*16L	4
C-5	Bageste dekorationsdæksel	ABS		1	I-8	Skrue	35	M8*60L	4

C-6	Skrue	35	M6*18L	2	I-9	Skive	35	φ 8* φ 19*2T	4
C-7	Skrue	35	M5*16L	2	J-1	DRIVHJUL		φ 260*6J	1
D	FRONTSTABILISATOR	Q235		1	J-2	AKSEL		φ 17*188	1
D-1L	Endekappe (V)	PP		1	J-3	Skrue	35	M8*12L	3
D-1R	Endekappe (H)	PP		1	K-1	MØTRIK		M8*7T	2
D-2	Skrue	35	ST2.9*18	4	K-2	LEJEHUS			1
E	Hovedramme	Q235		1	K-3	Skive	Q235	φ 8* φ 22*1T	2
E-1	Kabel		650L	1	K-4	PRESSEPLADE			1
E-2	knop		M16*22	1	K-5	Skrue		M8*20L	1
E-3	PLASTRØR	PP	φ 60	1	K-6	Fjeder	65Mn	φ 16* φ 2.5	1
E-4	Sensorledning		230L	1	K-7	Skive	35	φ 10.2* φ 13*0.3T	1
E-5	Skrue	35	M3*8L	1	K-8	Skive	35	φ 8* φ 14*2T	1
E-6	Bælte		430J6	1	L	MAGNETISK HUS			1
E-7L	Kædeafdækning (oppe)	ABS		1	L-1	Skive			1
E-7R	Kædeafdækning (lav)	ABS		1	L-2	Skrue		M8*55L	1
E-8	Skrue	35	ST3.9*50	7	L-3	Fjeder			1
E-9	Tråd		230L	1	M-1	SVINGHJUL		φ 280*32W*8KG	1
E-10	Skrue	35	3/16"*3/4"	6	M-2	LEJE		6003	1
E-11	Skrue	35	M8*20L	2	M-3	LEJE		6300	1
E-12	Ben venstre		9/16"	1	M-4	LEJE		6203	1
E-13	Ben højre		9/16"	1	M-5	Envejsleje		φ 35*17	1
E-14	DÆKKE	ABS		1	M-6	aksel		3/8"-26*130L	1
E-15	Skalstang	ABS		2	M-7	Skive	35	φ 30* φ 34*30.8T	1
E-16	Skalstang	ABS		2	M-8	Lejehus		φ 34*8J	1
E-17	Leje		6203	2	M-9	Leje		6000	1
E-18	Skive		φ 17.5* φ 25*0.3T	1	M-10	Skrue			2
E-19	Flad skive	35	φ 17.5* φ 25*0.3T	1	M-11	møtrik			2
E-20	C klip			2	M-12	busk		9mm	1
E-21	C klip			2	O	adapter			1
F-L	Pedal Venstre			1	P	motor			1
F-R	Pedal Højre			1					
G	BAGSTE STABILISATOR			1					
G-1L	ENDEHÆTTE Venstre	PP		1					
G-1R	ENDEHÆTTE Højre	PP		1					
G-2	Skrue	35	ST3.9*10L	4					

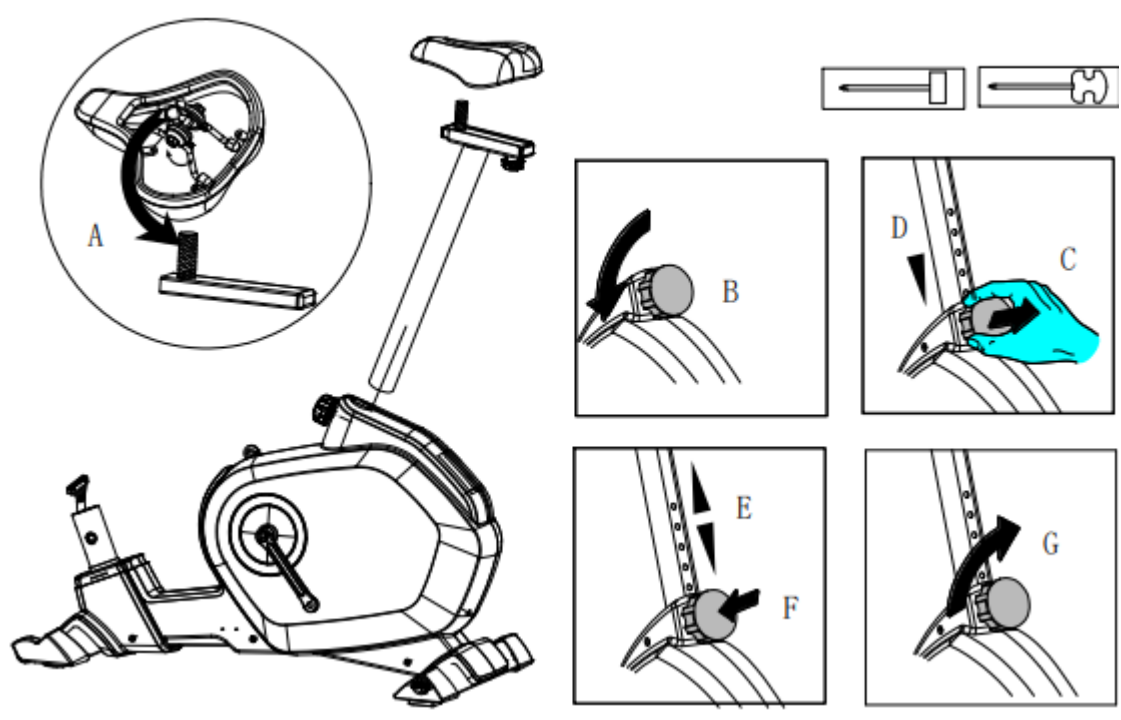
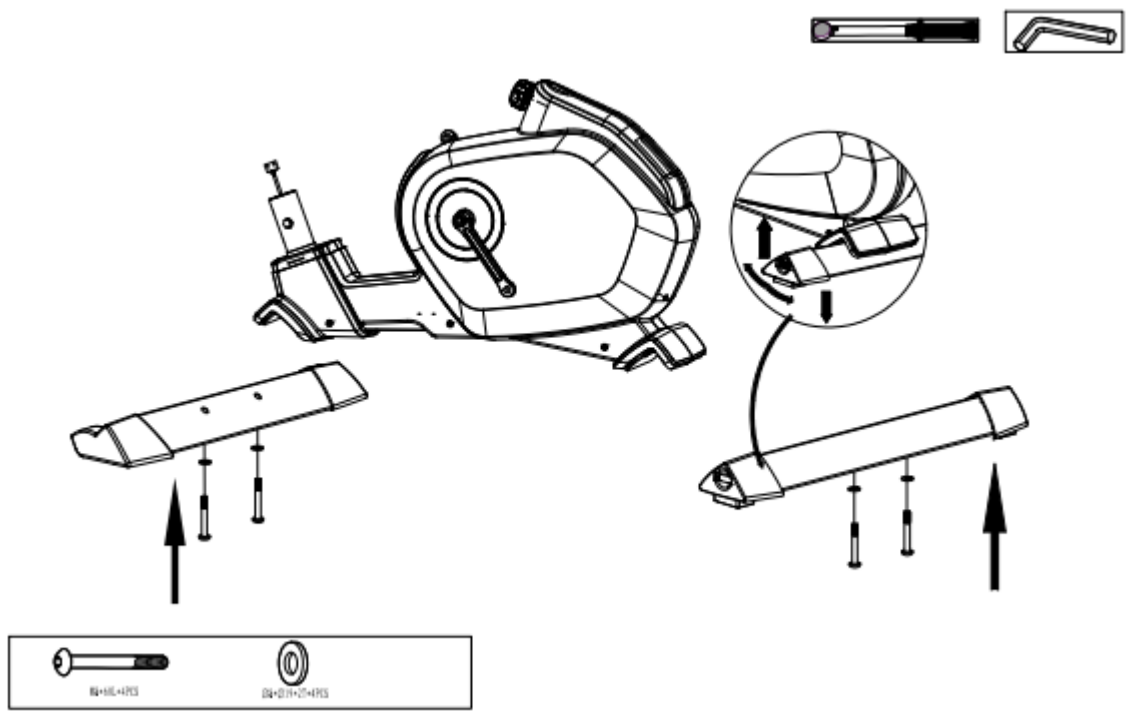

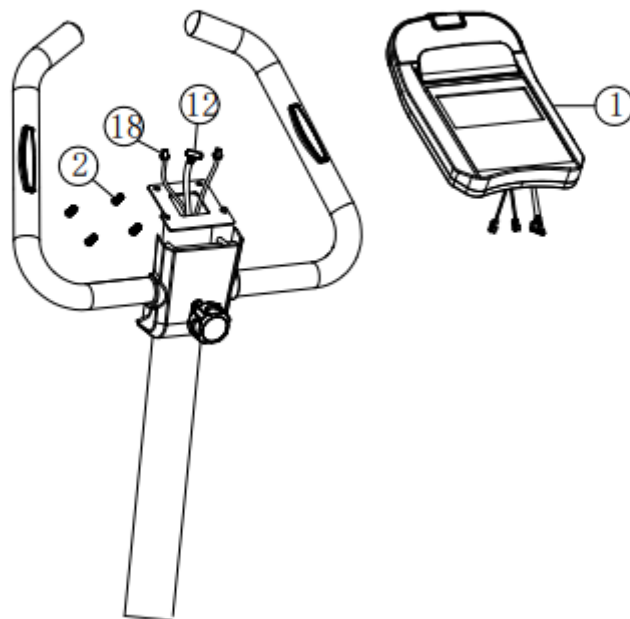
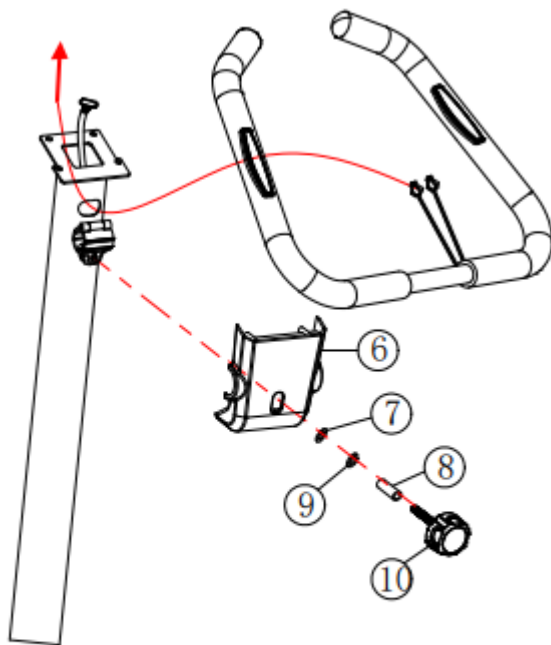

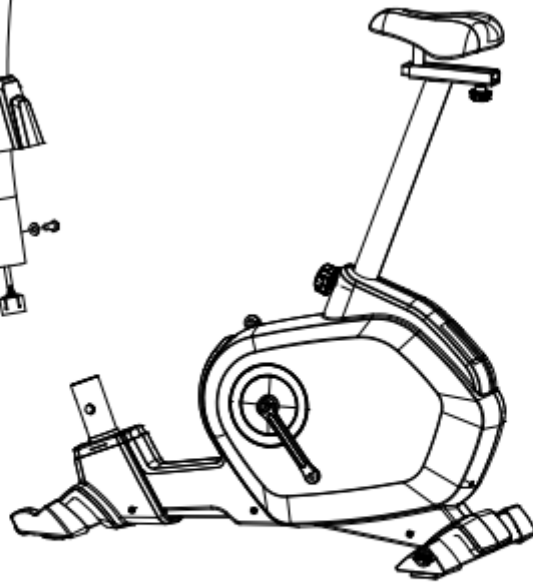
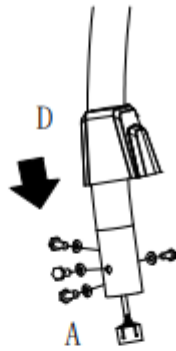
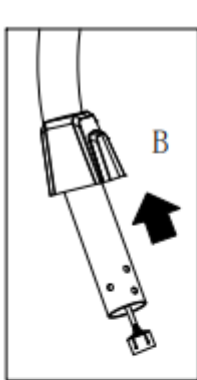
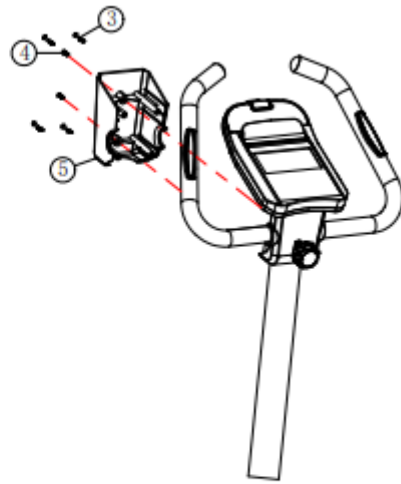

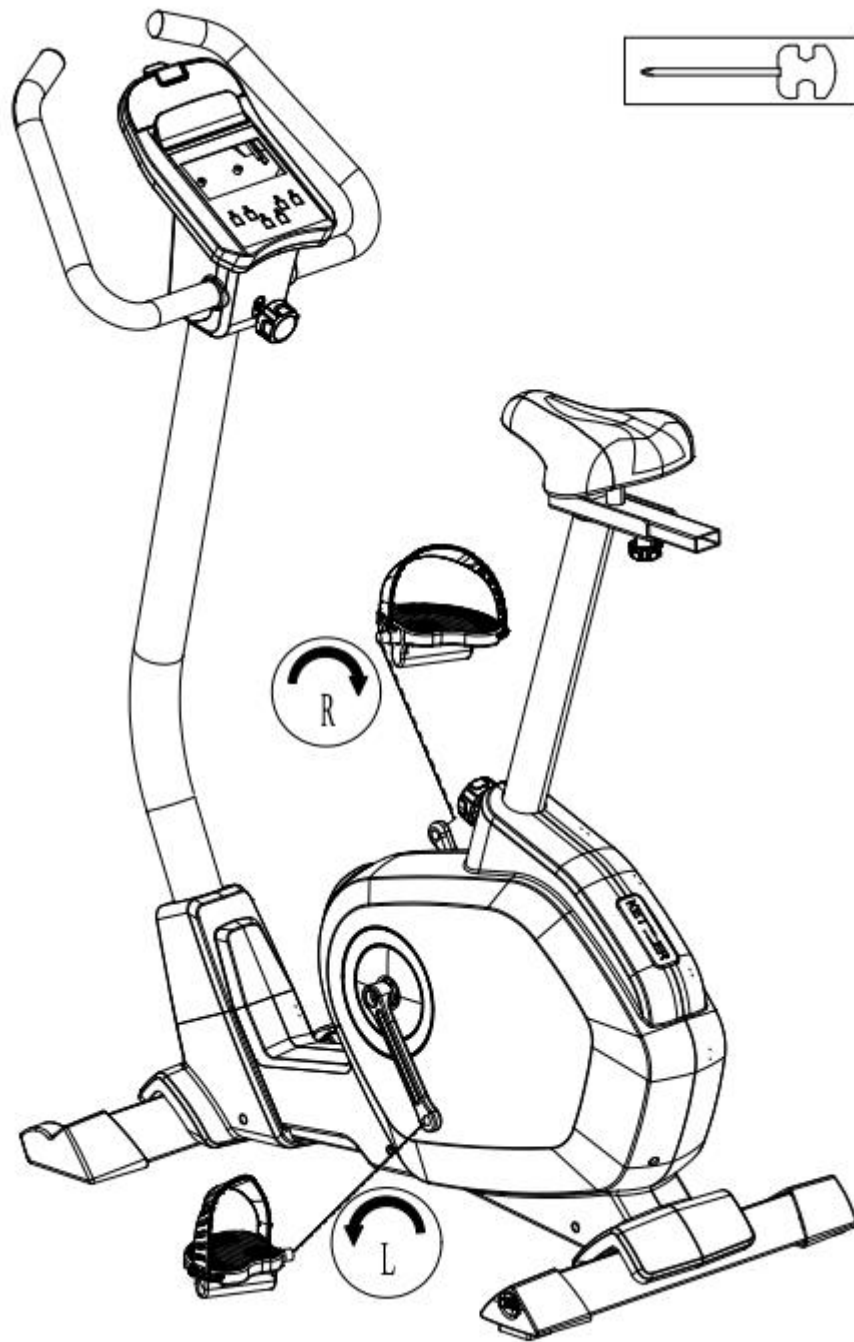

*** VIGTIG SIKKERHEDSINFORMATION ***

FØLG VENLIGST SIKKERHEDSREGLERNE NEDENFOR FOR AT UNDGÅ SKADER OG/ELLER ULYKKER.

1. HOLD CYKLEN UTILGÆNGELIG FOR BØRN. LAD IKKE BØRN VÆRE I NÆRHEDEN, NÅR DU BRUGER MASKINEN.
2. KØR IKKE STÅENDE PÅCYKLEN.
3. KØR IKKE MED LØS BEKLÆDNING, LØSE BUKSER ELLER NEDERDEL PÅ.
4. BRUG ALTID GUMMISKO ELLER TENNISKO, NÅR DU KØRER.
5. PLACER CYKLEN PÅ EN GLAT, HÅRD OVERFLADE.
6. BRUGERENS MAKSIMAL VÆGT ER 100 KG.
7. CYKLENS BREMSESYSTEM ER HASTIGHEDSAFHÆNGIG.
8. ANVENDELSESOMRÅDET ER TIL HJEMMEBRUG.
9. FØR HVER BRUG SKAL DU SIKRE, AT ALLE BEFESTIGNINGSMETODER PÅ ENHEDEN ER ORDENTLIGT FASTSPÆNDT. HVIS DE ER DEFEKT, SKAL DU HOLDE UDS TYRET UTILGÆNGELIGT FOR BRUG INDTIL REPARATION.
10. BREMSEKLODSENE ER MEST TILGÆNGELIGE FOR SLITAGE. FØR BRUG SKAL DU SIKRE, AT DE FUNGERER.
11. UDS TYRETS SIKKERHEDSNIVEAU KAN KUN OPRETHOLDES, HVIS DET UNDERSØGES GRUNDIGT FOR SKADER OG SLITAGE.
12. DENNE CYKEL ER IKKE EGNET TIL TERAPEUTISK BRUG.

OPVARMNINGSØVELSER



15 seconds for each



20 seconds

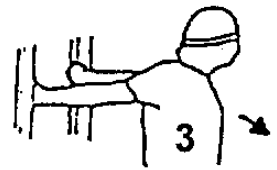

20 seconds

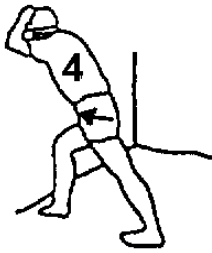

25 seconds

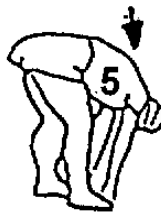

20 seconds



20 seconds



30 seconds



25 seconds for each leg

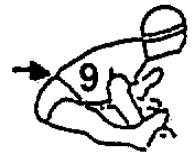

30 seconds



20 seconds



5 seconds x 3 times



20 seconds

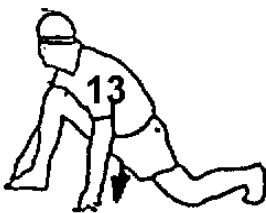

20 seconds for each leg

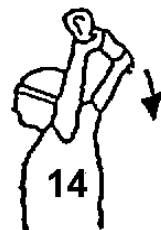

5 times

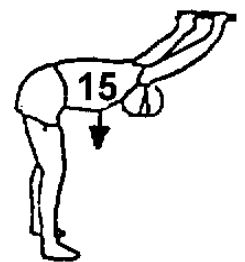

15 seconds

Manufactured in China for:
Sport Scandinavia A/S
Niels Bohrsvej 2. 9900 Frederikshavn. DK
Tel: +45 70 126 126. E-mail: Info@spsca.dk
www.spsca.dk